

Shenzhen Bede Mold CO.,Ltd

深圳市贝得科技有限公司

Factory Address:98 Industrial Area,Zhongxin Rd.,Xinqiao Street,Bao'an District, Shenzhen, China
Office Phone:+8675527084976 Mobile:+8615989309421 Email:kerrykim@szbede.com contact: kerry kim

Hex Head Bolts ISO 4014 (DIN 931)

The most common type of fastener, a hex head bolt is designed to be tightened with a standard spanner or ratchet and socket. Popularly used in all assemblies, a standard hex bolt is a staple across the world. Manufactured to ISO 4014 or DIN 931, and therefore includes an unthreaded section of the shaft. A hex drive permits a greater torque load to be applied to the joint over most other drive types.

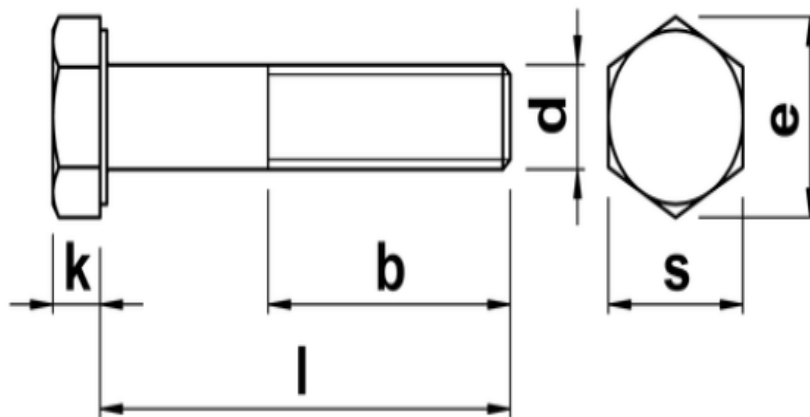

d	b min. <= 125	b min. > 125	s	k min.	e
M3	12	-	5.5	2.0	6.01
M4	14	-	7	2.8	7.66
M5	16	-	8	3.35	8.79
M6	18	24	10	3.85	11.05
M7	20	26	11	4.80	12.12
M8	22	28	13	5.15	14.38
M10	26	32	16(17)	6.22	18.90
M12	30	36	18(19)	7.32	21.10
M14	34	40	21(22)	8.62	24.49
M16	38	44	24	9.82	26.75
M18	42	48	27	11.28	30.14
M20	46	52	30	12.28	33.53
M22	50	56	34(32)	13.78	35.72
M24	54	60	36	14.78	39.98
M27	60	66	41	16.65	45.20
M30	66	72	46	18.28	50.85
M33	72	78	50	20.58	55.37

Contact: whatsapp +8615915396878
Email kerrykim@szbede.com
website: www.precisionmoldcomponents.com

